

# APRIL SHOWERS

## Farm Trial & Arena Trials

Hosted by The Australian Shepherd Club of Washington

**April 24, 25, 26, 2015**

All ASCA Approved Herding Breeds Welcome  
On The Lamb Farm - Arlington, Washington

Judges: Kaye Harris of Berthoud, Colorado - Robyn Johnson-Garrett of Kuna, Idaho  
Registration: 7:30AM - Contestants meeting: 8AM - Trial begins: 8:30AM

### **Friday – Sheep Farm Trial**

Judge Robyn Johnson-Garrett

### **Friday - Arena Duck Trial**

Judge Kaye Harris - Ducks Course E

Duck trial contestants meeting 10:30am – duck trial 11AM

### **Saturday AM – Arena Trial**

Judge Kaye Harris - Sheep Course E

Judge Robyn Johnson-Garrett - Cattle Course A, Ducks Course E

### **Saturday PM – Arena Trial**

Judge Robyn Johnson-Garrett – Sheep Course E

Judge Kaye Harris - Cattle Course A, Ducks Course B

### **Sunday AM – Arena Trial**

Judge Kaye Harris - Sheep Course B

Judge Robyn Johnson-Garrett - Cattle Course B, Ducks Course B

### **Sunday PM – Arena Trial**

Judge Robyn Johnson-Garrett – Sheep Course B

Judge Kaye Harris - Cattle Course B, Ducks Course B

Farm Trial Divisions: Advanced, Open

Farm Trial Limit: 20 runs; 6 sheep/run

Arena Trial Divisions: Advanced, Open, Started, Novice Handler, Junior Handler, FEO

Arena Trial Entry Limit: 50 run limit / Judge / day; Available: cattle 20 runs/trial, sheep 80 runs/day, ducks 56 runs/day

Cattle 3-10 head, Ducks 5-10 head, Sheep 3-10 Head

Course E will be done with a gather

**PRE-ENTRY DATE:** postmarked March 10<sup>th</sup> thru April 10<sup>th</sup> - Entries postmarked before March 10<sup>th</sup> will not be accepted.

**checks payable to:** ASC of WA

**mail entries to:** Michelle Berryessa – P O Box 519, Roy WA 98580

Entries must be on the official [ASCA Stockdog Entry Form](#):

<http://www.asca.org/Portals/0/stockentwfill.pdf> [fill in form]

<http://www.asca.org/Portals/0/StockEntry.pdf>

Please write clearly -- include registration number or \*ASCA tracking number\*.

Entry must be signed. Please include e-mail address on entry forms to receive confirmation of entry.

**PRE-ENTRY FEE:** Ducks \$25 – Sheep \$35 – Cattle \$45 – Farm Trial \$50, Junior Stockdog Handler Class - half price

**DAY OF ENTRY** if available: 7:30AM; **DAY OF ENTRY FEE:** add \$5 to each class

### **\*ATTENTION OTHER BREED COMPETITORS\***

As of January 2003, all persons wishing ASCA to track scores towards ASCA titles, earned by their other breed dog at ASCA events, must register their dog with ASCA to obtain a **Tracking Number**. A one time tracking fee/dog of \$10 along with a one time, 1 year full or service, Membership to ASCA is required (\$10 for a service membership).

ASCA Service Membership and Tracking Form: <http://www.asca.org/Portals/0/trackapp.pdf>

Official waiting list will be kept - run order will be drawn prior to day of trial - bitches in season will run in order

#### AWARDS

All trials: 1st-4th Place ribbons

Farm Trial: High In Trial Aussie, High In Trial Other Breed.

Friday Duck Trial:

High In Trial Aussie, High In Trial Other Breed, High In Trial Open Working Junior, High In Trial Junior Stockdog Handler.

Saturday and Sunday each arena trial:

High In Trial Aussie, High In Trial Other Breed, High In Trial Open Working Junior, High In Trial Junior Stockdog Handler.

For the Day Saturday: Highest Score Advanced, Highest Score Open, Highest Score Started.

For the Day Sunday: Highest Score Advanced, Highest Score Open, Highest Score Started.

For the Weekend from either Fri, Sat, or Sundays Arena Trials: Highest Score Sheep, Highest Score Ducks, Highest Score Cattle.

High Combined Aussie, High Combined Other Breed - all advanced scores combined from Saturday & Sunday.

High Combined Open - all open scores combined from Saturday & Sunday.

High Combined Started Aussie, High Combined Started Other Breed - all started scores combined from Saturday & Sunday.

LUNCH: \$7 each day - everyone welcome.

SATURDAY NIGHT DINNER: Please join us at the Angel of The Winds Casino, Arlington, WA.

SITE INFORMATION: Bring weather protection for you and your dogs. Bring chairs. All dogs must be on leash at all times. Please plan to pick up after yourself and your dogs. Please adhere to off limit areas.

#### LOCATION

On The Lamb Farm - 10915 Moran Road, Arlington, WA

I-5, North or South, to Exit 208 = Arlington. Eastbound State Rt. 530 to traffic light at Highway 9 - turn right.

At 1<sup>st</sup> traffic light turn left onto East Highland Drive - this becomes Tveit Rd.

Turn left onto Moran road. Follow it around and down into the valley, all the way to the end.

#### LODGING

Quality Inn: exit 206; 200 172<sup>nd</sup> St NE, Arlington WA 360.403.7222

Arlington Motor Inn: exit 208; 2214 State Rt. 530 NE, Arlington WA 360.652.959

Smokey Point Motor Inn: exit 206; 17329 Smokey Point Drive, Arlington WA 360.659.8561

#### COURSE DIRECTORS

Friday: Marti Parrish - 425.334.6272 - [justusaussie@earthlink.net](mailto:justusaussie@earthlink.net)

Saturday & Sunday: Bob Bowles - 360.421.8382 - [soundviewaussies@msn.com](mailto:soundviewaussies@msn.com)

#### ASCA STOCKDOG RULES

The Australian Shepherd Club of America

6091 E State Hwy 21, Bryan, Texas 77808-9652, 409.778.1082

<http://www.asca.org/>

**Trial Setup Sunday Afternoon April 19<sup>th</sup>** - contact Bob or Marti for time

This event depends on volunteer efforts and we greatly appreciate your willingness to help.

Please contact your Course Directors if you are available to help.

Lunch will be provided at the trial on August 24, 25, and 26 for duck contractors, set up crew, and workers.

All ASCA Rules and Regulations apply

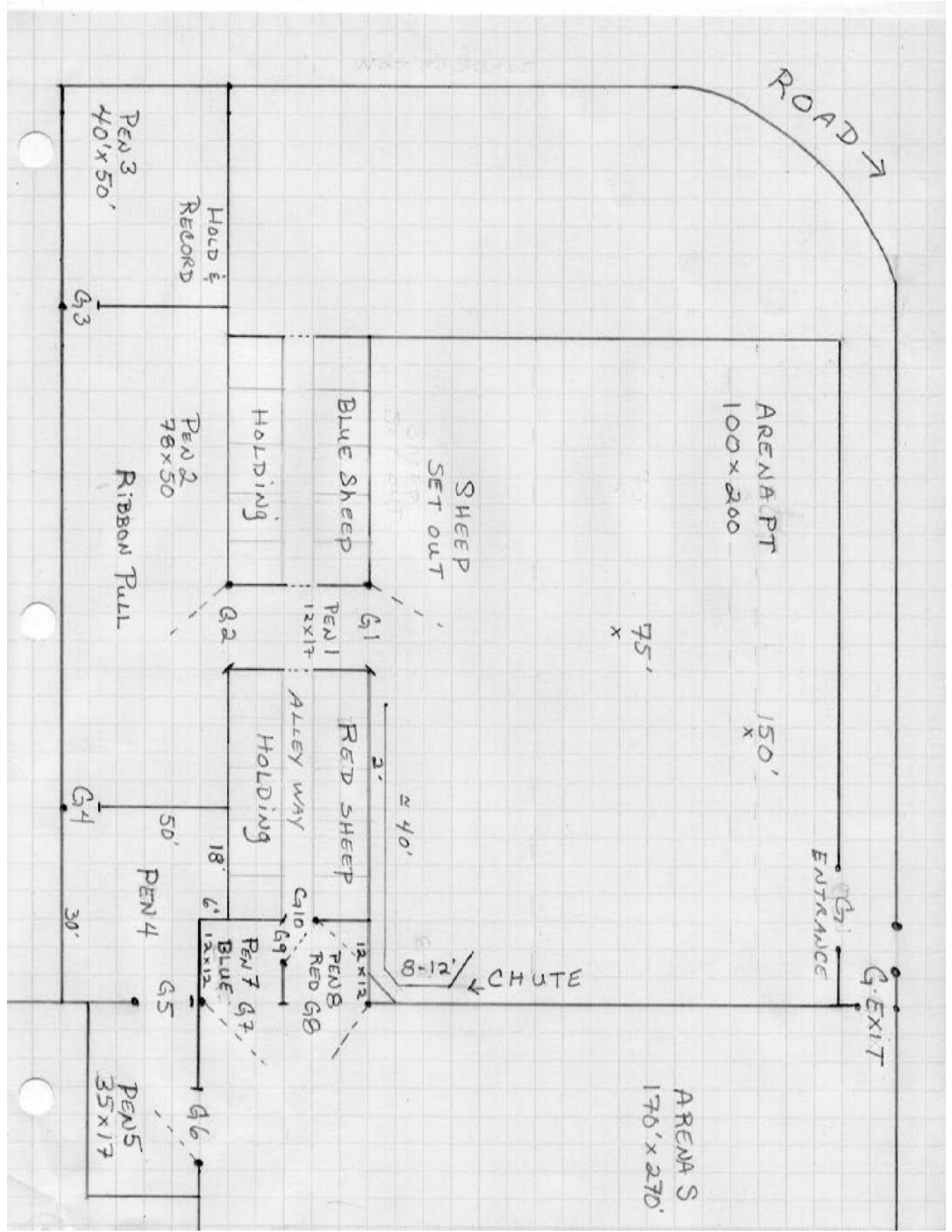

## **April Showers ASCA Farm Trial - Friday April 24, 2015 - On The Lamb Farm, Arlington WA**

Time 25 minutes – with 10 & 3 minute warnings. All tasks must be completed unless otherwise stated. All gates must be closed and properly latched as you go. Ties broken by score on chute, if still tied by score on gather.  
Enter from the road through Gate Entrance into Arena PT.

### **GATHER 150 feet – 20pts**

6 sheep (3 blue - 3 red) will be in the Arena PT set with food.

Advanced handler must stay at or behind the 150ft mark during the gather. Dog must stay at or behind the 150ft mark until sent.

Open handler must stay at or behind the 75ft during the gather. Dog must stay at or behind the 150ft mark until sent.

**Time starts** when handler sends dog. Gather sheep to the handler. Task ends. Next task begins.

### **CHUTE – 20pts**

Advanced handler - dog must drive the sheep from the point of gather into the chute. Handler need not stay at the 150 foot mark.

Open handler - dog may drive or fetch the sheep from the point of gather to the chute. Handler is free to move.

Handlers may not enter the chute.

Drive sheep through the chute, to and through Gate 1 into Pen 1. Task ends. Next task begins.

### **PEN #1- 5pts**

Close Gate 1, move sheep through Pen 1, out Gate 2, into Pen 2, close Gate 2. Task ends. Next task begins.

### **RIBBON PULL – 20pts**

Settle sheep any where in Pen 2 except on the south wall next to holding pens.

Advanced handler must pull ribbon from the red sheep first, then pull ribbon from the blue sheep.

Open handler must pull ribbon from the only ribboned sheep.

Task ends. (task need not be accomplished to continue). Next task begins.

### **PEN #3 – 5 pts**

Move sheep out of Pen 2, through Gate 3, into Pen 3. Close Gate 3. Pause task. Next task begins.

### **HOLD and RECORD- 20pts**

Hold sheep near the clipboard, which is attached to the fence. Record number of ear tag of one red sheep and of one blue sheep onto clipboard. Task ends. (task need not be accomplished to continue). Resume Pen 3.

Move sheep from Pen 3, out Gate 3, into Pen 2. Task ends. Next task begins.

### **Pen #2 – 5pts**

Close Gate 3, move sheep through Pen 2, out Gate 4, into Pen 4. Task ends. Next task begins.

### **PEN #4 – 5pts**

Close Gate 4, move sheep through Pen 4, out Gate 5, into Pen 5. Task ends. Next task begins.

### **PEN #5 – 5pts**

Close Gate 5, move sheep through Pen 5, out Gate 6, into Arena S. Task ends. Next task begins.

### **SORT – 25pts**

All six sheep must arrive in Arena S to begin the sort. Close Gate 6.

Using Gates 7, 8, and 9, sort - 3 red marked sheep into Pen 8 and 3 blue marked sheep into Pen 7.

Release red sheep from Pen 8, thru Gate 10, down alley way, keep dog out of alley way.

Red sheep holding pen will be open, move red sheep into holding pen and close gate.

Return to Pen 7, release blue sheep through Gate 9, into alley way, keep dog out of alley way. Close and latch Gate 10.

Task ends.

Close and latch Gate 9. Exit through Pen 7 or Pen 8 into Arena S.

When ALL GATES are closed and latched **time stops**.

Exit Arena S through Gate Exit to the road.